

EWRC 300-500 LX

Cold Face Family • Quick Start



INTRODUCTION

This section is designed to get you up and running in the shortest possible time. It contains basic information on the EWRC300 – 500LX. Should you need more detailed information, please refer to the remainder of the manual.

Out of the box, the EWRC300 – 500LX is set up for standard Electrical Defrost applications. It can be altered for Hot Gas or Off Cycle applications if needed.



MECHANICAL ASSEMBLY

- Remove the coverplate on the right side of the door, pressing lightly on the points indicated by the arrows in Figure 1 and open the door.
- Drill holes in the backplate at the top or bottom to pass the wires through. See the example in figure 2.
- Screw the backplate to the wall using 4 screws (not supplied) to match the holes illustrated in Figure 3.
- Shut the door by securing it with the 2 screws provided. Replace the screw caps removed earlier from the door (see point a).

- The door lock (an optional accessory) can be installed in 3 different positions on the door, the holes to be drilled are indicated on the back. Each position on the door represents a different position where the disconnecter can be mounted. N.B.: to make it easier to wall mount the backplate, remove the door by pressing lightly on the left side (the side that the door is attached by). You will also have to separate the base from the keypad by disconnecting the keypad cable.

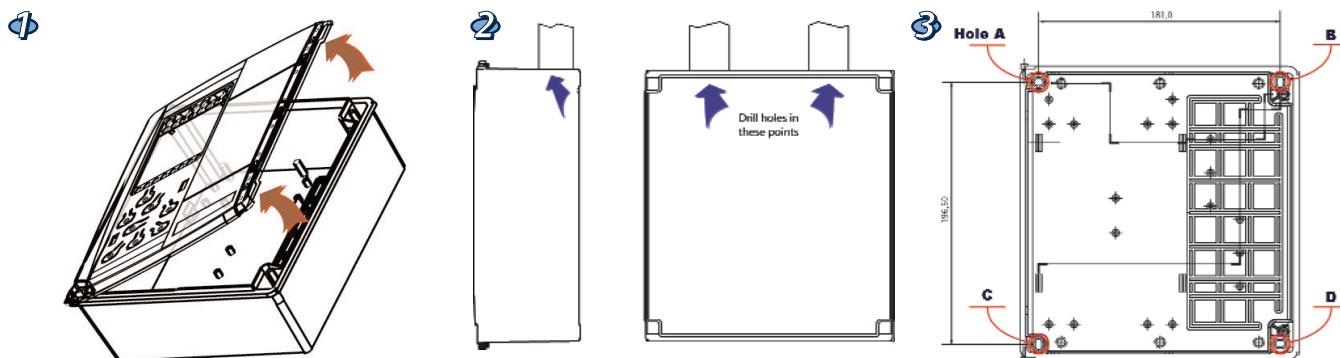

WIRING DIAGRAM

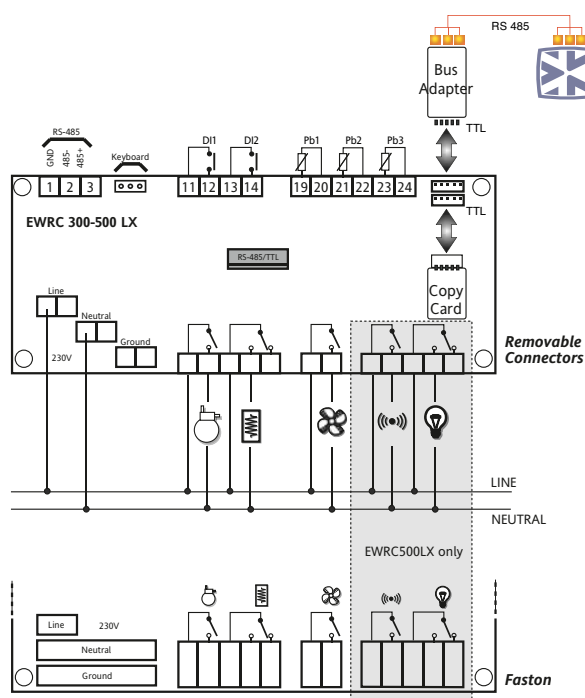

INPUTS / OUTPUTS DEFAULT SETTINGS

Output relays (default settings)

- Out (relay) 1 = Compressor (or liquid line valve)
- Out (relay) 2 = Defrost
- Out (relay) 3 = Evaporator fan
- Out (relay) 4 = Alarm (EWRC500LX only)
- Out (relay) 5 = Light (EWRC500LX only)

Note: It is possible to change the function of each relay, see parameters H21 to H25

Probe Inputs

- Pb1 = Regulation Probe
- Pb2 = Defrost Termination Probe
- Pb3 = Not required (except in special applications)



Top Display 3 figures with + /- sign shows:

- Process Value
- parameters' labels,
- alarms, functions

Bottom Display 4 figures shows:

- parameters' value,
- function state / other

KEYS

Nr.	KEY	press and release	press approx 3 sec	Note
A	UP	Scroll Increase Values	HACCP menu	H31
B	ESC	Exit Function Menu	manual defrost	H32
C	SET	Change SetPoint Set Date / time Enable Functions	Configuration Menu	
D	DOWN	Scroll Decrease Values	/	H33
E	ENERGY SAVING	Enable Energy Saving	Night and Day Menu	H37
F	POWER	Switch On / Off device	drip	H34
G	LIGHT	Switch On / Off Light	forced ventilation	H35
H	AUX	Aux	/	H36

LEDS

Nr.	LED	color	ON	BLINK	OFF	Note
1	POWER	red	Power ON	/	Power OFF	
2	ALARM	red	Alarm	Silenced	No Alarm	
3	HACCP	red	HACCP Alarm	Not Viewed	No Alarm	HACCP models
3	PANIC	red	Panic Alarm	/	No Alarm	
5	COMPRESSOR	yellow	Compressor ON	delay	Compressor OFF	
6	DEFROST 1	yellow	defrost	drip	No defrost	
7	EVAPORATOR FANS	yellow	Fans ON	forced ventilation	Fans OFF	
8	DEFROST 2	yellow	defrost	drip	No defrost	
9	CONDENSER FANS	yellow	Fans ON	/	Fans OFF	
10	LIGHT	yellow	Light ON	/	Light OFF	
11	AUX	yellow	AUX ON	/	AUX OFF	
12	DCC	green	Deep Cooling Cycle ON	/	Deep Cooling Cycle OFF	
13	ENERGY SAVING	yellow	Energy Saving ON	/	Energy Saving OFF	
14	NIGHT AND DAY	yellow	Night and Day ON	/	Night and Day OFF	RTC models
15	HACCP	yellow	HACCP Menu	/	Other Menu	HACCP models

These are the most commonly used parameters. Their factory default values will suit normal electrical defrost applications. You can alter them to better suit your particular application if you need to.

FOLDER	LABEL	DESCRIPTION	RANGE	DEFAULT	M.U.	Note
	SEt	Regulation SetPoint		0	°C/°F	CutOut
CPr	diF	Differential	0 ... 30.0	2.0	°C/°F	Related to SetPoint
CPr	HSE	Higher Set point adjustment limit	LSE ... HdL	50.0	°C/°F	Minimum User can adjust SetPoint
CPr	LSE	Lower Set point adjustment limit	LdL ... HSE	-50.0	°C/°F	Maximum User can adjust SetPoint
CPr	dOF	Compressor Antishort cycle	0 ... 255	0	min	Minutes
dEF	dtY	Defrost Mode	0 ... 2	0	num	Electrical Defrost (1=HotGas)
dEF	dit	Interval between defrost	0 ... 255	6	h/min/sec	Hours
dEF	dCt	defrost interval Counting mode	0 ... 3	3= RTC models / 1	num	Time elapses since start of last defrost
dEF	dEt	Maximum duration of Defrost	1 ... 255	30	h/min/sec	Minutes
dEF	dSt	Defrost termination temperature	-302.0 ... 1472.0	6.0	°C/°F	
dEF	dPO	Execute a Defrost at Power On	n/y	n	flag	
FAn	FSt	Evaporator Fan Stop temperature	-302.0 ... 1472.0	6.0	°C/°F	
FAn	Fdt	Fan delay after defrost	0 ... 255	0	min	Minutes
FAn	dt	Drip time	0 ... 255	0	min	Minutes
FAn	dFd	Fan Stop during defrost	n/y	y	flag	
ALr	HAL	Maximum alarm threshold	LAL ... 1472.0	50.0	°C/°F	
ALr	LAL	Minimum alarm threshold	-302.0 ... HAL	-50.0	°C/°F	
ALr	dAO	defrost Alarm Override	0 ... 999	60	min	Alarm delay after defrost
ALr	tAO	Temperature Alarm Override	0 ... 255	0	min	Temperature alarm delay
diS	LOC	Lock keyboard	n/y	n	flag	
diS	PA1	Password 1 (USr)	0 ... 999	0	num	
diS	ndt	number display type	n/y	y	flag	
diS	CA1	Offset Probe 1	-30.0 ... 30.0	0.0	°C/°F	Regulation Probe
diS	CA2	Offset Probe 2	-30.0 ... 30.0	0.0	°C/°F	Defrost termination Probe
diS	ddl	Lock display during defrost	0 ... 2	2	num	Display shows "DEF"
CnF	H00	Probe Type	0/1	1	flag	0=PTC; 1=NTC depending on model
CnF	H42	Defrost termination Probe presence	n/y	y	flag	Always present

HOW TO CHANGE THE SET POINT

- Press and release the SET button.
- The Top Display shows SET, the bottom display shows the value
- Use the UP & DOWN buttons to adjust the Set Point's value
- Press ESC for display to return to normal

HOW TO ENTER THE USER LEVEL (USR) AND ALTER PARAMETER VALUES

- Press & Hold the SET button for 3 seconds until the display changes to show USr
- Press & release SET to enter USr (User Level).
- The first parameter is displayed. Top display shows the parameter label, Bottom display shows parameter value.
- Using the UP & DOWN buttons, go to the desired parameter
- Press & release SET, then using the UP & DOWN buttons, adjust the parameter's value.
- Press ESC several times to return to normal display
- Press & Hold the SET button for 3 seconds until the display changes to show InS
- Use the UP or DOWN button to display InS
- Press & release SET to enter InS (InStaller Level).
- The first parameter folder is displayed
- Keep pressing SET until you see the folder you want
- Press the UP or DOWN button, the first parameter is displayed. Top display shows the parameter label, Bottom display shows parameter value.
- Using the UP & DOWN buttons, go to the desired parameter
- Press & release SET, then using the UP & DOWN buttons, adjust the parameter's value.
- Press ESC several times to return to normal display

ALL OTHER PARAMETERS ARE CONTAINED IN INSTALLER LEVEL (InS)

Entering Installer Level (InS):

You should only need to do this for more advanced applications. Here the parameters are arranged in folders (Compressor / Defrost / Fans etc)

Eliwell Controls s.r.l.

Via dell'Industria, 15 • Zona Industriale Paludi • 32010 Pieve d'Alpago (BL) ITALY

Telephone +39 0437 986 111 • Facsimile +39 0437 989 066

Sales +39 0437 986 100 (Italy) • +39 0437 986 200 (other countries) • E-mail saleseliwell@invensyscontrols.com

Technical helpline +39 0437 986 300 • E-mail techsuppeliwell@invensyscontrols.com

www.elowell.it

cod. 9IS44112-1 - GB - rel. 07/08

© Eliwell Controls s.r.l. 2008 All rights reserved.

FOR MORE DETAILED INFORMATION READ ON Technical Sheet p/n 9IS44058

